

Volumetric feeder

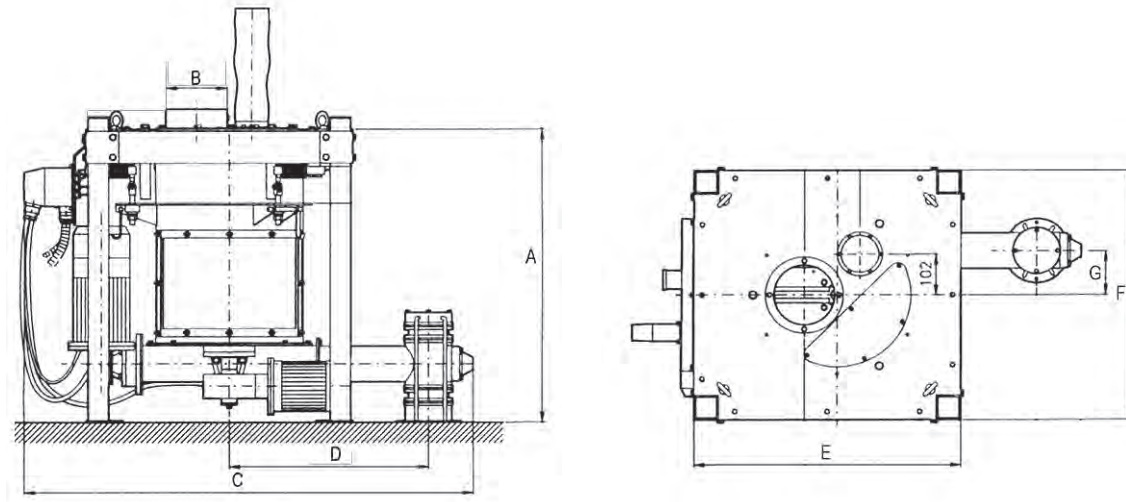

	Dimensions (mm)						
	A	B	C	D	E	F	G
VCD025	729	150	1095	486	650	620	110
VCD050	729	150	1095	486	650	620	110
VCD100	729	150	1095	486	650	620	110

	Minimum Capacity	Maximum Capacity	Hopper Volume	Installed Power (kW)	Air Consumption at 6 Bar	Aspiration required
VCD025	20 dm ³ /h	500 dm ³ /h	40 Liters	0,5	/	/
VCD050	40 dm ³ /h	1000 dm ³ /h	40 Liters	0,5	/	/
VCD100	80 dm ³ /h	2000 dm ³ /h	40 Liters	0,5	/	/

Technical features of the equipment can be modified without any obligation of notice. Data may be not fully in accordance with market versions.

effegielle s.r.l.
imeco
automazioni



Via Amedeo Tonani, 4/b
26030 Malagnino - Cremona - Italia

Tel. + 39.0372.49.68.26
Fax +39.0372.49.68.47

info@imeco.org www.imeco.org

VCD

MIXING
DOSING

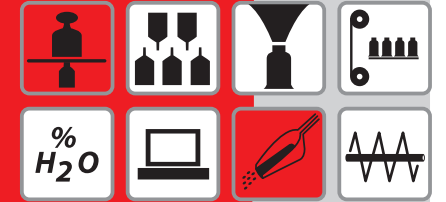

VCD

Volumetric feeder for powder products dosing

VCD

effegielle



effegielle s.r.l.
imeco
automazioni



CONCEPTION

The electronic feeder Mod. VCD is essentially composed of:



1	Surge hopper (OPTIONAL)
2	Support frame
3	dosing hopper
4	Extracting screw
5	Inside agitator
6	Operator panel complete with frequency converter (inverter)

PURPOSE OF THE MACHINE

The Mod. VCD has been designed for the VOLUMETRIC dosing of powder products with high accuracy.

The Model VCD can be used for dosing of:

- **Micro ingredients inside of a discontinuous mixing system (ascorbic acid, additives, etc.)**
- **Micro ingredients inside of a continuous mixing system (Vitamins, additives, ascorbic acid, dry gluten, etc.)**

If needed, because of machine changes, the Model VCD can be easily up grade to a Model ACM, (loss in weight weigher) with a kit of load cells and control microcomputer, increasing reliability and accuracy of dosing.

OPERATION PRINCIPLE

The product to be dosed is put into the machine through the surge hopper or a auger feeder on the top of the VCD.

The product comes into the dosing hopper.

The product is moved by the ASPO and the extraction is facilitated by the screw.

The screw turns controlled by an inverter.

The inverter receives the input voltage signal (0-10 V) which is proportional to the speed that the screw has to keep constant. (by a remote signal or by a local regulation).

By a potentiometer on the electric panel of the machine, it is possible to regulate the additive percentage to deliver, on the grounds of a reference signal from a MASTER machine.

On demand, the Model VCD can be manufactured in stainless steel.



The various models differ only for the auger and the motor drive reduction ratio.

ACCURACY & RELIABILITY



The careful design and the use of a sophisticated control electronics, assure a high accuracy and reliability.



Product inside the VCD is continuously agitated by a MIXER. The mixer motorization is independent to avoid product bridges and clogging inside the weighing hopper.